

# LOCALLY STOCKED CABINETS



**WOLF CLASSIC**<sup>™</sup>

# Now Available at ProSource

## Locally Stocked & Ready for Pick up

We've expanded our product selection to include locally stocked Wolf cabinets and vanities, offering simple to install cabinet designs available at ProSource Wholesale® - and at low wholesale prices.

We are partnering with Wolf to bring our members and their clients premium, locally stocked cabinetry in a classic & high-demand style. With shortened lead times and the ever-popular white shaker style, our locally stocked Wolf cabinets are perfect to complete any project.



Grantley White (stock) and Midnight Complement Paint Color (non-stock)

## ProSource Beats the Competition with:

- Professional Design Services
- Convenient One-Stop Shopping
- Dedicated Account Management
- Large Private Showrooms
- Widest Product Selection
- And More!

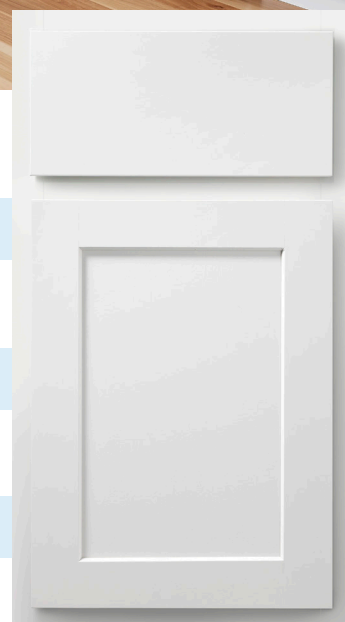

**DOOR STYLE:**  
Grantley | White

# Wolf Cabinetry

## FEATURES & BENEFITS

- Locally stocked
- Plywood Construction
- 5-Year Manufacturer's Warranty
- Soft-Close Doors & Drawers
- Plywood Dovetail Drawers
- Quick Availability
- Matching Interior Finish (White)

### Wolf Classic Cabinets™

[Available at ProSource!](#)

Stylish. Practical. Affordable. The Wolf Classic collection offers high-quality cabinets with features typically found in more expensive lines, enabling you to build a dream kitchen at a value price.

### Time = Money

[Stock Cabinetry Means Faster Turnaround!](#)

At ProSource, we understand the needs of our trade pro members. That's why we maintain locally stocked cabinetry in the most popular white styles. Locally stocked means a faster turnaround on your projects!



Grantley White (stock) and  
Midnight Complement Paint Color (non-stick)

# Cabinet Specifications

## GRANTLEY



Face Frame	3/4" thick x 1-1/2" wide solid wood face frame
Side Panels	1/2" thick plywood with color matching exterior
Back Panel	1/2" thick plywood
Top/Bottom	1/2" thick plywood
Interior	White with white interior
Shelves	3/4" thick plywood, adjustable, with locking shelf clip Bull-nosed, foil covered front edge clip Half-depth, adjustable base
Corner Blocks	3/4" thick all-wood
Hanging Rail	1/2" thick - horizontal
Drawers	5/8" thick solid wood, clear finished Dovetail - 4" high 1/4" thick plywood bottom
Glides	Soft close, full extension undermount
Hinges	Soft close, 6-way adjustable
Door/Drawer Front	HDF door with recessed MDF center panel

# Product Characteristics & VARIATIONS

---

## Painted Finishes

Paint finishes are uniquely different from stained finishes. On all painted products, expansion and contraction are typical due to changes in climate conditions. Due to the normal movement, paint finishes may develop separation lines, finish breaks and seam lines. These will be most notable at stile, rail and panel joints. Joint separations may become more noticeable over time and through season changes.

Some of the grain pattern and characteristics (checks, pin knots) as well as seams and joints will remain visible through the paint finish. These are normal and are not considered quality defects. Seam lines and finish breaks are normal characteristics of paint finishes and should not be considered a reason for product replacement. Over time, there may be a slight color shift due to exposure to natural and artificial light.

## Joint Fracture

Wood is in a constant state of expansion and contraction, therefore hairline fractures will soon be noticeable at the joints on the cabinet face frame. These will not weaken the finish, but they will be noticeable.

## The Effect of Light on Paint

While a painted finish is a classic look for cabinets, it is important to remember that colors may appear changed under differing lighting conditions.

- Incandescent bulbs generate yellow light that intensifies warm colors but tends to dull cooler colors
- Halogen bulbs produce brighter, white light that is more like sunlight
- Fluorescent bulbs generate cool, blue light that deepens blues and greens but softens warmer colors
- Soft white fluorescent bulbs imitate the warmth of incandescent bulbs, but all colors can appear faded in their light
- Full-spectrum fluorescents produce light that most closely represents natural sunlight

# Cabinet Care & MAINTENANCE

Like all investments in your home, your cabinetry will require proper maintenance to keep looking its best. Please be sure to regularly clean and care for your cabinetry using the guidelines below.

## CABINET CARE

- Wipe up spills, splatters and water spots as they occur - keep the cabinets dry.
- Clean as needed with a soft, lint-free cloth. Use a mild detergent or soap and warm water.
- Use a fresh cloth when wiping down cabinets. Even when thoroughly rinsed, cleaning cloths may still have remnants of bleach, detergents, grease or other materials which can be harmful to the finish of your cabinetry.
- Avoid using a dishcloth or sponge, which may have remnants of detergents and grease on them.
- Dry surfaces immediately with a soft cloth.
- Never use bleach, ammonia or any cleaning agents that contain any abrasives.
- Never use scouring pads, steel wool or powdered cleaners.
- Do not allow oven cleaners to come in contact with wood finishes.
- Avoid placing small kitchen appliances where heat is directed onto cabinet surfaces.
- Avoid draping damp cloths or dishtowels over cabinet doors - excessive moisture can cause permanent damage.

## EXTERIOR FINISH

- The finish on your cabinetry does not require waxing or the application of wood oils to maintain the wood. However, if you desire a glossy or shiny appearance, you may apply furniture polish or lemon oil that is recommended for furniture use.
- Before applying polish to your cabinets, be sure they are thoroughly cleaned and dry.
- Be sure not to use any cleaning compounds that may contain alkaline agents, which can negatively impact furniture surfaces.
- If not thoroughly wiped clean, these polishes and oils can either create a hazy look or act as an attractant to dust and dirt.
- Painting in the same room as your cabinetry? We recommend Scotch brand painter's tape style 600 or 610 when preparing to paint around your Wolf Classic cabinetry.

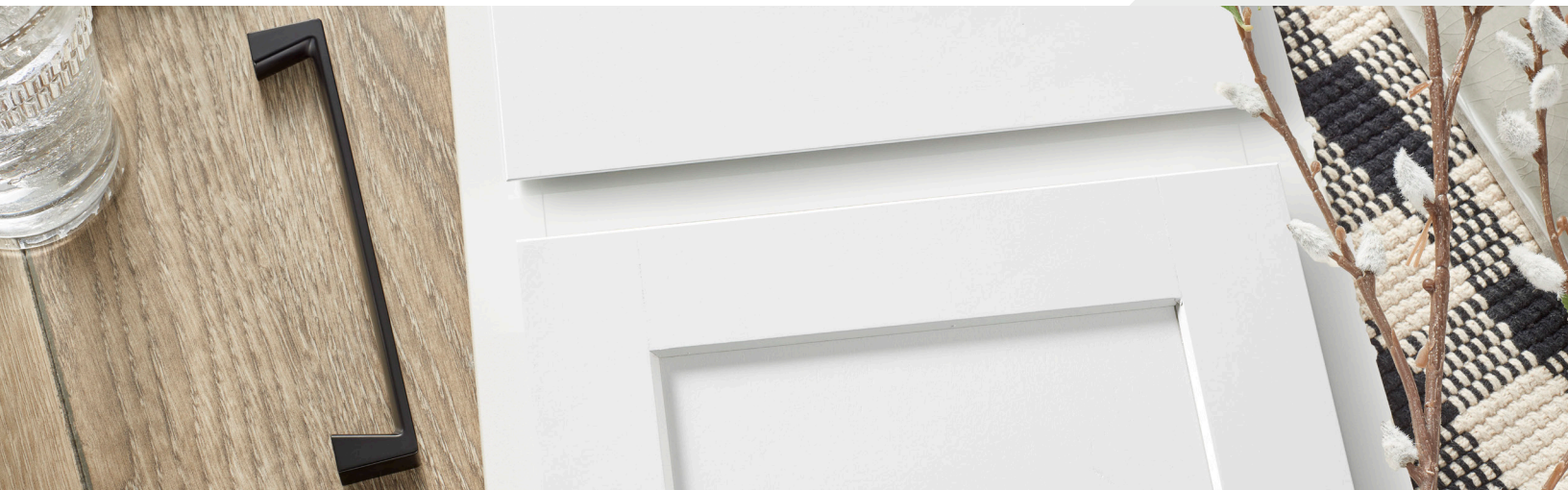

# Common Door HINGE ADJUSTMENTS

## Tightening the hinge

1. From repeated opening and closing, it might be necessary to tighten screw 1, which attaches the door to the frame of the cabinet.

## Adjusting doors for level/plumb

1. To raise or lower your door, simply loosen screw 1 on all hinges attached to that door, and manually raise the door up or down to the desired height. Tightening the screw will set the door in place.
2. To adjust the door forward or backward, adjust screw 2. Turning the screw clockwise will move the door back, closer to the cabinet frame. Turning the screw counterclockwise will extend the door away from the cabinet frame.
3. To adjust the door left or right, loosen screw 3. Turning the screw clockwise will adjust the door to the left. Turning the screw counterclockwise will adjust the door to the right.

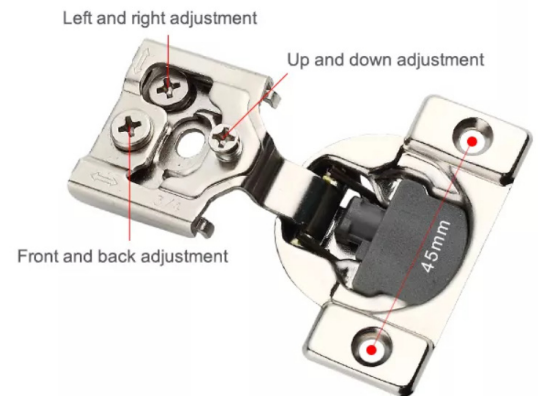

Soft-Close Hinge

# DRAWER ADJUSTMENTS

Due to normal shipping, handling and delivery, it is common for drawers to require on-site adjustments. Common adjustments include assuring that the drawers are square, plumb and aligned with adjacent cabinets.

## Drawer Head Adjustment

1. Remove the drawer box from the cabinet.
2. Loosen, but do not fully remove, either the left or right screw on the back of the drawer head.
3. With the screw loosened, adjust your drawer head to be fully plumb and level.
4. Once the drawer head is set to your liking, tighten the screw, taking care not to allow the screw to follow the previous hole in the drawer head.

Drawers with undermount glides can also be adjusted at the glide mechanism. This adjustment can be done either by removing the drawer from the glides or by leaving it in place and working underneath the drawer while it is pulled out. Locate the sliding plate on the mechanism. Slide the plate back and forth on each side, checking for level, until you achieve the desired alignment.

## Remove Drawers From Undermount Drawer Guides

1. Remove drawer from track by fully opening the drawer.
2. Reach under the drawer and squeeze in the locking levers at the same time and remove the drawer from the track.
3. To replace the drawer, set the drawer back on the tracks and push the drawer completely in until you hear a click and the levers have engaged the clips.

# 5-Year Manufacturer's LIMITED WARRANTY



Wolf Classic cabinets have been manufactured under the highest standards of quality and workmanship.

## Five-Year Limited Warranty on Cabinets, Drawer Guides and Hinges

Wolf Home Products warrants to original consumer purchasers for five years from date of original purchase that cabinets, drawers, drawer guides and hinges used in the manufacture of Wolf Classic cabinets shall be free from defects in material and workmanship under normal use.

## General Warranty Guidelines

Should Wolf Classic cabinets fail during the applicable warranty period due to defects in the material or workmanship under normal use, Wolf Home Products, at its discretion, will repair or provide the parts necessary to replace the defective products.

This warranty is applicable only to products used in residential applications in the United States and is not transferable.

This warranty does not cover products that are misused, abused, mishandled, improperly installed, improperly stored, changed, modified or subject to extreme temperatures or extreme moisture levels, or normal wear and tear. This warranty is not valid for products used for any purpose other than the purpose for which they were originally intended. This warranty does not cover the cost of installation, removal, subsequent damage or transportation of the defective product, regardless of whether the work was performed by a contractor, service company or the consumer.

Variations in color and grain pattern are a natural characteristic of wood. Color changes also may result from exposure to light, heat, smoke, household cleaners, and other elements and environmental conditions that are part of the aging process. These material variations and changes are not covered by this warranty. Wolf Home Products reserves the right to substitute for discontinued product the most similar product in styling, wood species and color available at the time a claim is submitted.

Paint finishes are uniquely different from standard wood finishes. On all wood products, expansion and contraction are typical due to changes in climate conditions. Due to this normal movement, paint finishes may develop slight separation lines, finish breaks and seam lines. With use of selected hardwoods and veneers, some grain patterns and wood characteristics (checks, pin knots) as well as seams and joints will remain visible through the paint finish. Over time, there may be a slight color shift, due to exposure to natural and artificial light. These normal conditions are not considered quality defects and are not covered by this warranty.

**THIS WARRANTY IS THE EXCLUSIVE WARRANTY OF WOLF HOME PRODUCTS AND IS IN LIEU OF AND WOLF HOME PRODUCTS DISCLAIMS ALL OTHER WARRANTIES, EXPRESS OR IMPLIED, INCLUDING THE IMPLIED WARRANTIES OF MERCHANTABILITY AND FITNESS FOR A PARTICULAR PURPOSE.** Some states do not allow the exclusion or limitation of incidental or consequential damages, so the above limitations or exclusions may not apply to you. This warranty gives you specific legal rights and you may also have other rights that vary from state to state.

To submit a claim under this warranty, contact ProSource Wholesale or email Wolf Cabinets explaining the defect along with photos and a dated sales receipt as proof of purchase: [WolfCabinetsWarranty@wolfleader.com](mailto:WolfCabinetsWarranty@wolfleader.com)



# Stock Cabinets

WALL 12" HIGH-12" DEEP

SKU

WALL 15" HIGH- 12" DEEP

SKU

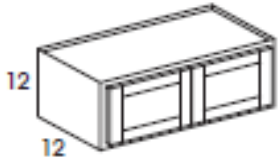

W3012  
W3312  
W3612

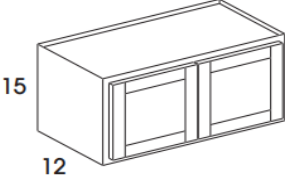

W3015

WALL 18" HIGH-12" DEEP

SKU

WALL 24" HIGH- 12" DEEP

SKU

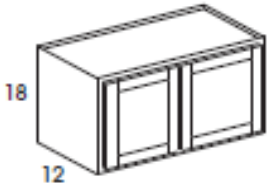

W3018

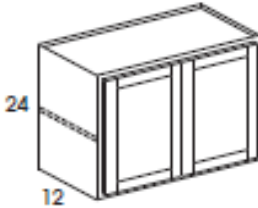

W3024  
W3324  
W3624

WALL 30" HIGH- 12" DEEP

SKU - SINGLE DOOR

SKU - DOUBLE DOOR

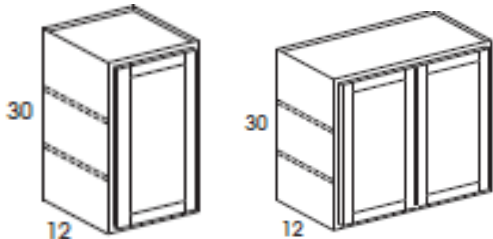

W0930  
W1230  
W1530  
W1830  
W2130

W2430DD  
W2730  
W3030  
W3330  
W3630

WALL 42" HIGH- 12" DEEP

SKU - SINGLE DOOR

SKU - DOUBLE DOOR

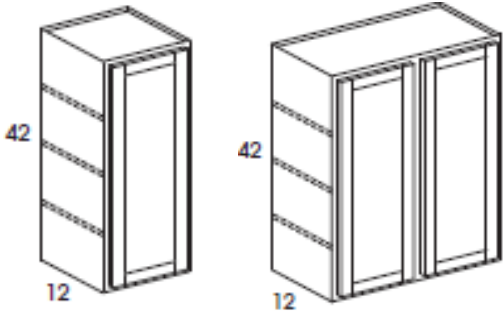

W0942  
W1242  
W1542  
W1842  
W2142

W2442DD  
W2742  
W3042  
W3342  
W3642

REFRIGERATOR WALL 12" HIGH  
- 24" DEEP

SKU

REFRIGERATOR WALL 24" HIGH  
- 24" DEEP

SKU

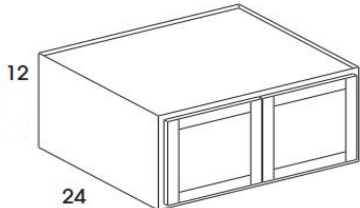

RW3612

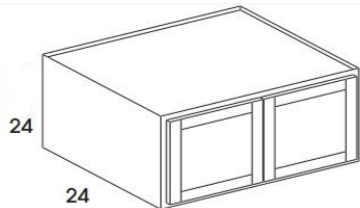

RW3324  
RW3624

\*All single door wall cabinets are hinged left. Flip wall cabinet during install for right hinge applications.

\*\*All single door base & tall cabinets are hinged left. Reverse door during installation for right hinge applications.

DIAGONAL CORNER WALL 12" DEEP

SKU

WALL EASY REACH 12" DEEP

SKU

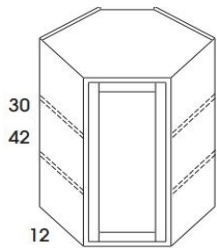

WDC2430  
WDC2442

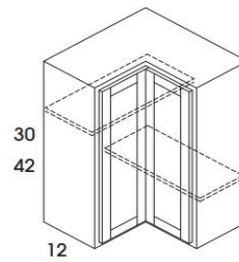

WER2430  
WER2442

WALL CORNER 12" DEEP

SKU - SINGLE DOOR

SINKBASE 34-1/2" HIGH - 24" DEEP

SKU

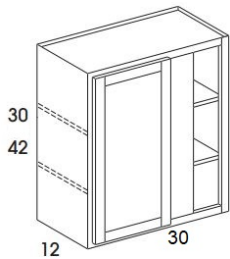

WC3030  
WC3042

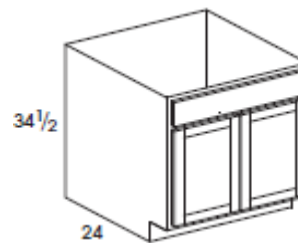

SB24DD  
SB33  
SB36

BASE 34-1/2" HIGH - 24" DEEP

SKU - SINGLE DOOR

SKU - DOUBLE DOOR

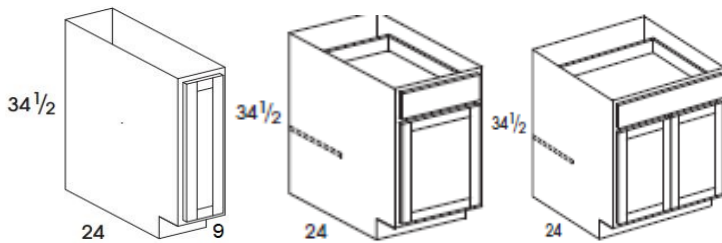

B09FH  
B12  
B15  
B18  
B21

B24DD  
B27  
B30  
B33  
B36

3 DRAWER BASE 34-1/2" HIGH - 24" DEEP

SKU

BASE CORNER 34-1/2" HIGH - 24" DEEP

SKU

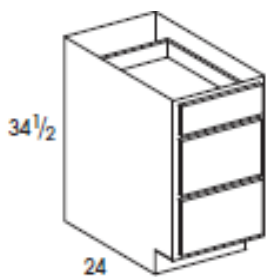

DB12D3  
DB15D3  
DB18D3  
DB24D3  
DB30D3

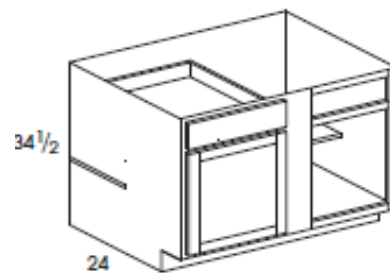

BC36

BASE SUPER SUSAN 34-1/2" HIGH - 23-1/4" DEEP

SKU

BASE EASY REACH 34-1/2" HIGH - 18" DEEP

SKU

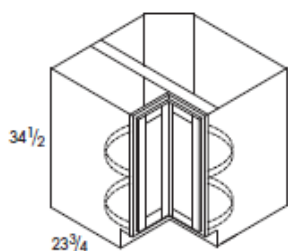

SS36

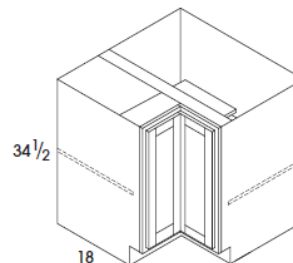

BER36

\*All single door wall cabinets are hinged left. Flip wall cabinet during install for right hinge applications.

\*\*All single door base & tall cabinets are hinged left. Reverse door during installation for right hinge applications.

BASE MICROWAVE 34-1/2" HIGH  
- 24" DEEP

SKU

BASE WASTE BASKET 34-1/2" HIGH  
- 24" DEEP

SKU

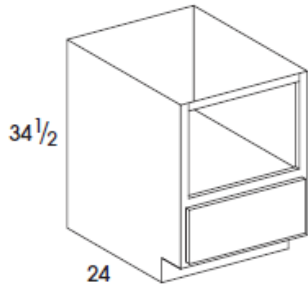

BMW30

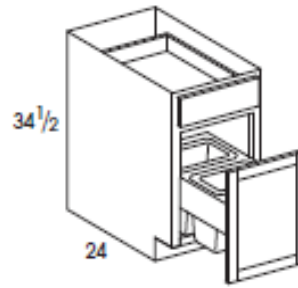

BWB18

UTILITY CABINET - 24" DEEP

SKU

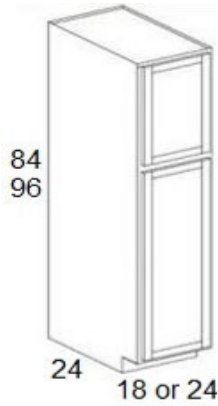

- Shelves not included
- Unfinished toekick is attached to all utility cabinets

18" WIDE

U188424

U189624

24" WIDE

U248424

U249624

UTILITY CABINET SHELF KIT

SKU

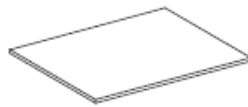

- SHELFKIT includes four shelves and clips
- 1824 shelf: 22-3/16" X 16-3/16"
- 2424 shelf: 22-3/16" X 22-3/16"

U1824SHELFK  
U2424SHELFK

VANITY SINK BASE 34-1/2" HIGH  
- 21" DEEP

SKU

VANITY DRAWER BASE 34-1/2" HIGH  
- 21" DEEP

SKU

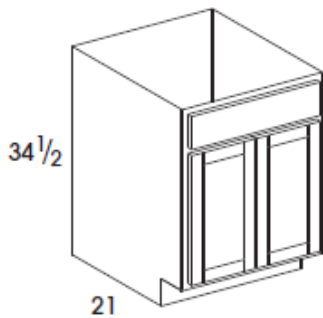

VSB24DD  
VSB30

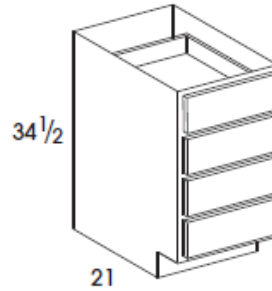

VDB12  
VDB15  
VDB18

VANITY SINK DRAWER BASE 34-1/2" HIGH  
- 21" DEEP

SKU - BUTT DOORS

SKU - CENTER STILE

BUTT DOORS

CENTER STILE

VSDB36

VSDB42

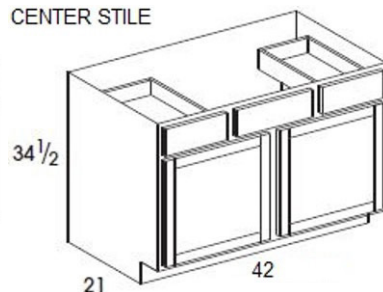
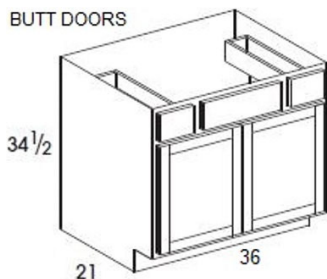

\*All single door wall cabinets are hinged left. Flip wall cabinet during install for right hinge applications.

\*\*All single door base & tall cabinets are hinged left. Reverse door during installation for right hinge applications.

LINEN CABINET 84" HIGH - 21" DEEP

SKU

LC158421

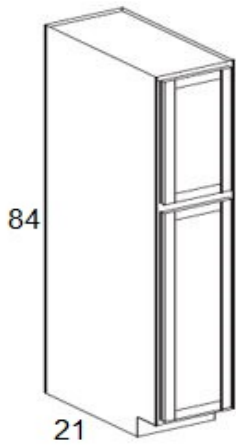

- Shelves not included
- Unfinished toe-kick is attached
- Available width: 15"

LINEN SHELF KIT

SKU

LC1521SHELFK

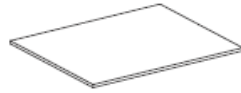

- Includes four shelves
- Does NOT include shelf clips
- Shelf clips must be ordered separately

SHELF CLIP

SKU

00Y SHELF CLIP

- Sold individually
- Sixteen clips needed per shelf kit

FILLER - STANDARD

SKU

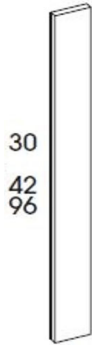

- Fillers are 3/4" thick solid maple
- Fillers are finished on the face, left, and right sides; however, the sides receive a lesser finish

3" WIDE  
F330  
WF342  
F396

6" WIDE  
WF642  
F696

PANELS

SKU

- Finished end panel, 48" x 36" x 1/4" - vinyl
- Finished end panel, 48" x 96" x 1/4" - vinyl
- Finished Refrigerator panel, 3/4" x 24" x 96" (Finished on 2 sides and 1 long edge)

P4836V  
P4896V  
3/4REFP24

DISHWASHER END PANEL WITH 3" STILE

SKU

REFRIGERATOR END PANEL WITH 1-1/2" STILE

SKU

DWP3

REFP24

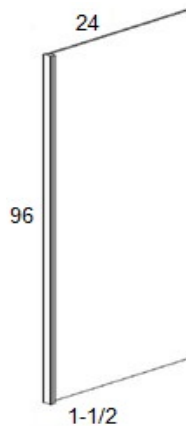
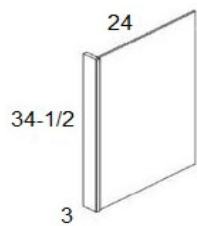

\*All single door wall cabinets are hinged left. Flip wall cabinet during install for right hinge applications.

\*\*All single door base & tall cabinets are hinged left. Reverse door during installation for right hinge applications.

REVERSIBLE CROWN MOLDING - 8 FT LONG

SKU

REVCROWN

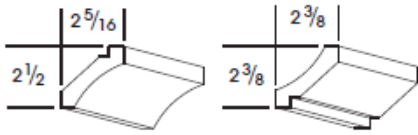

SCRIBE - 8 FT LONG

SKU

MSW

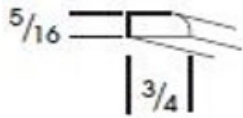

QUARTER ROUND - 8 FT LONG

SKU

MQR

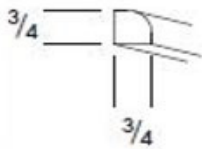

INSIDE CORNER (MINI COVE) - 8 FT LONG

SKU

MICW

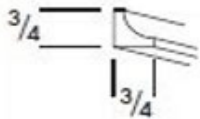

OUTSIDE CORNER - 8 FT LONG

SKU

MOCW

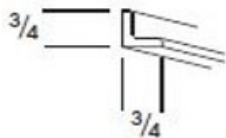

TOEKICK - 4-1/2" - 8 FT LONG

SKU

TOEKICK

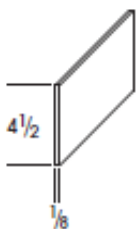

TOUCH UP KIT

SKU

038 TUKIT

- Touch up kit includes:
- (1) Putty fill stock
  - (1) Touch up marker
  - (1) Small bottle of top coat

\*All single door wall cabinets are hinged left. Flip wall cabinet during install for right hinge applications.

\*\*All single door base & tall cabinets are hinged left. Reverse door during installation for right hinge applications.

# Stock Cabinet

## NOMENCLATURE

### Cabinet Nomenclature Breakdown Examples

W2436 =	<b>W</b> Cabinet Abbreviation	<b>24</b> Width	<b>36</b> Height
B24 =	<b>B</b> Cabinet Abbreviation	<b>24</b> Width	
RW3624 =	<b>RW</b> Cabinet Abbreviation	<b>36</b> Width	<b>24</b> Height

### Stock Cabinet Abbreviations

B = Base cabinet	RW = Deep refrigerator wall cabinet
B_FH = Base w/ full height door	SB = Sink Base
BC = Base blind corner	SS = Super Lazy Susan
BER = Base easy reach	U = Utility
BMW = Base microwave cabinet	VDB = Vanity drawer base
BWB = Base waste basket	VSB = Vanity sink base
DB_D3 = Drawer base with 3 drawers	VSDB = Vanity sink drawer base
DWP = Dishwasher end panel	W = Wall cabinet
F = Filler	WC = Wall blind corner
LC = Linen cabinet	WDC = Wall diagonal corner
P = Panel	WER = Wall easy reach
REFP = Refrigerator end panel	WF = Wall filler

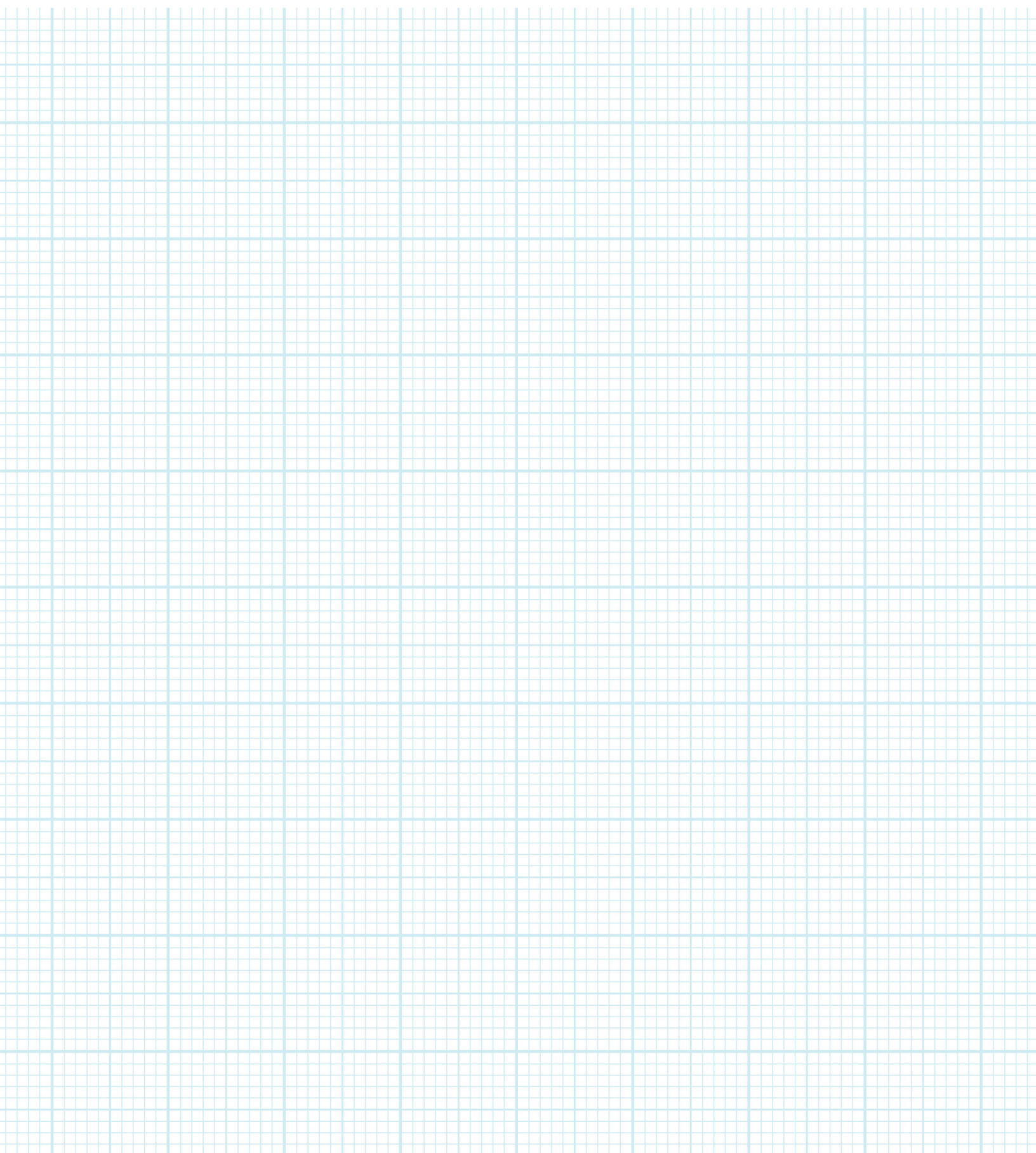

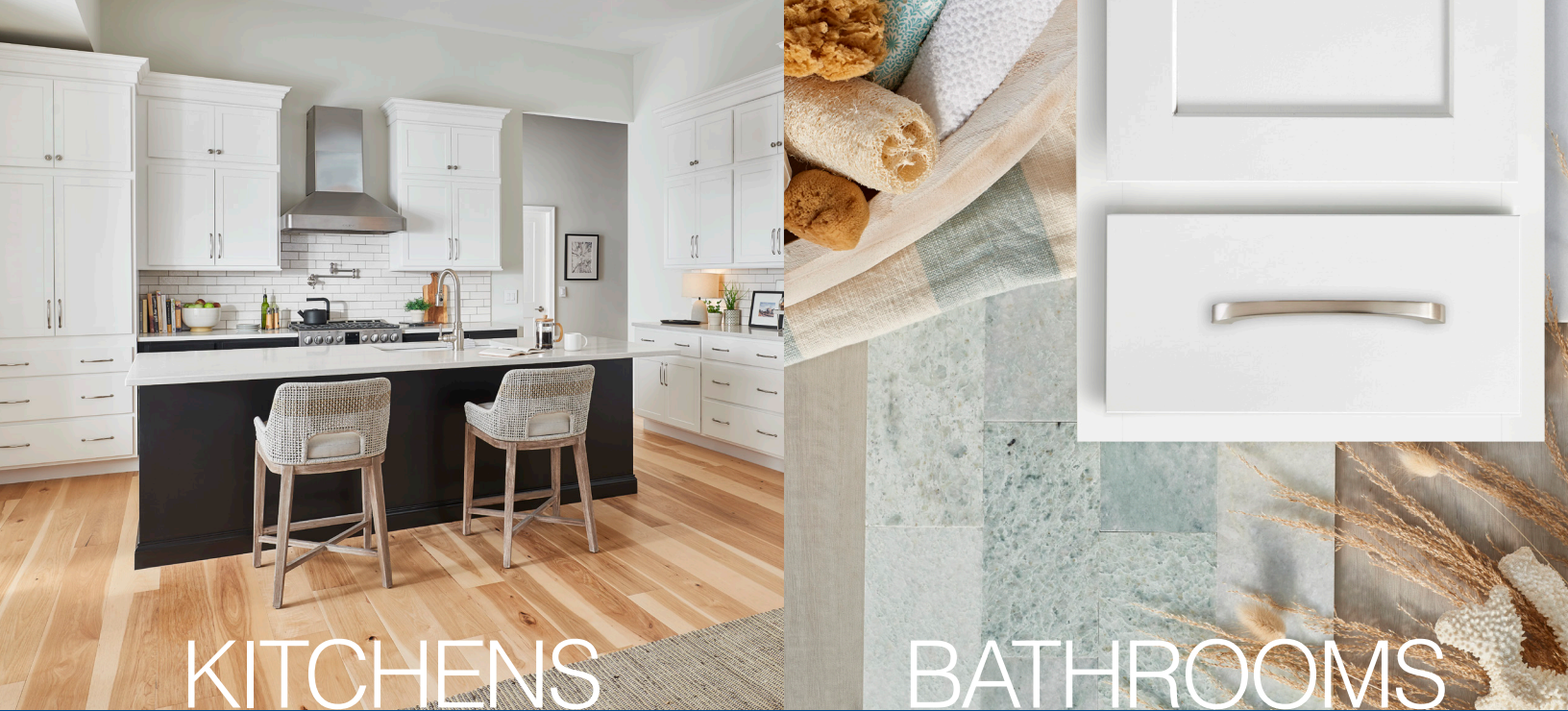

KITCHENS

BATHROOMS

Create beautiful spaces on a budget!

Locally Stocked Cabinetry

**ProSource**<sup>®</sup>  
**WHOLESALE**

Products & Pros for Home & Commercial Projects

### 3 CONVENIENT LOCATIONS

ProSource of Bloomington

9201 Penn Ave. S., Suite #36 | Bloomington, MN 55431 | 952-881-7388

[www.prosourcewholesale.com/bloomington](http://www.prosourcewholesale.com/bloomington)

ProSource of Plymouth

14330 21st Avenue North | Plymouth, MN 55447 | 763-390-9700

[www.prosourcewholesale.com/plymouth](http://www.prosourcewholesale.com/plymouth)

ProSource of St. Paul

6866 33rd Street, Suite 140 | Oakdale, MN 55128 | 651-482-8700

[www.prosourcewholesale.com/stpaul](http://www.prosourcewholesale.com/stpaul)

**WOLF CLASSIC**<sup>™</sup>